



**Sound Absorption Coefficient according to EN ISO 354:2003
Laboratory measurements**

Applicant: ARTFAZIUM – ENGINEERING UNIPESSOAL Lda.

Date of test: July 29th, 2.015.

Test specimen: Komodo Absorber panels of 595x595mm. See details in the report.

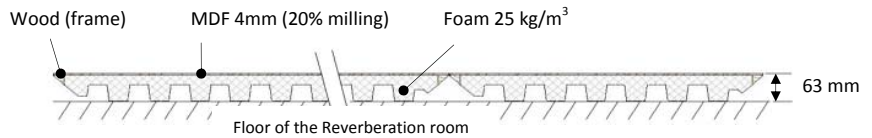

Room without test specimen:

22,5 °C, 62%, 955 mbar

Room with test specimen:

22,6 °C, 63%, 955 mbar

Reverberation room volume: 209,6 m³

Reverberation room area: 211,8 m²

S = 11,44 m²

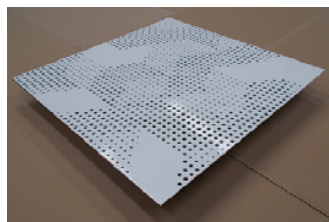

f (Hz)	T ₁	T ₂	α _s	α _p
100	8,93	6,23	0,14	0,25
125	8,56	4,74	0,28	
160	9,70	4,93	0,29	
200	10,14	4,11	0,43	0,60
250	9,74	3,31	0,59	
315	9,08	2,84	0,71	
400	8,99	2,44	0,88	
500	9,07	2,17	1,03	1,00
630	8,81	2,00	1,14	
800	8,19	1,98	1,13	
1000	7,67	2,14	0,99	1,00
1250	7,07	2,33	0,85	
1600	6,29	2,44	0,74	0,65
2000	5,47	2,50	0,64	
2500	4,71	2,38	0,61	
3150	3,92	2,10	0,65	
4000	3,17	1,92	0,61	0,60
5000	2,45	1,77	0,47	

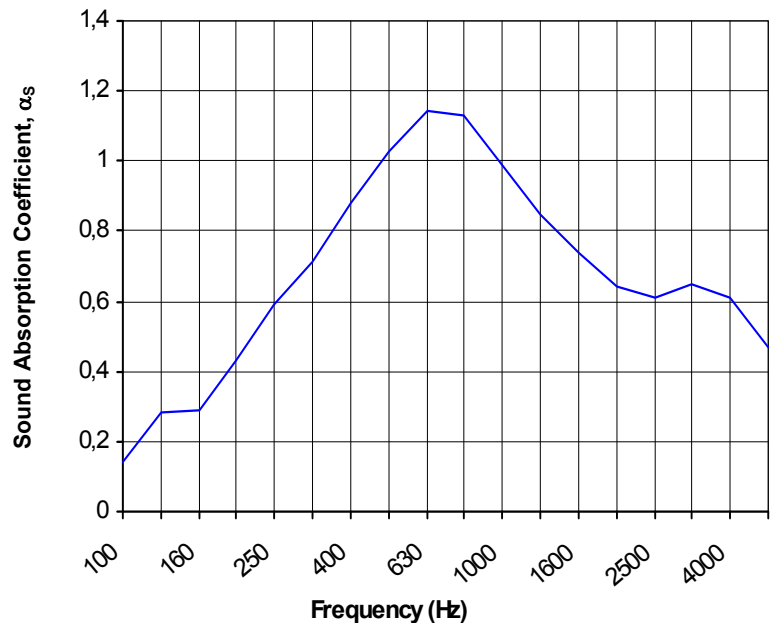

Weighted according to EN ISO 11654:1997

Sound Absorption coefficient:

α_w = 0,70 (M)

Acoustic class:

C

Evaluation based on laboratory measurement obtained by an engineering method.

Uncertainty associated to global index α_w: ± 0,1.

tecnalia Inspirin Business

ENAC
ENSAYOS
Nº 4 / LE 4 5 6



Nº of result: B2015-20-M247

Signature:

Acoustics Area

Managed by

tecnalia

Date of report: September 7th, 2.015.